

Base Preparation

I. GENERAL INFORMATION

The **Pliteq GenieBoard® 300** line of products for impact sound insulation is engineered to provide better performance than any other board available, and has been rigorously tested to achieve proven results. **GenieBoard** is a universal shiplap flooring board which can be used as a direct alternative to gypsum concrete or multiple plywood and cement board layers. **GenieBoard** is connected using screws or staples at 12" OC along board joints with a **Pliteq** adhesive, it can be used directly under all flooring types and on top of all **GenieMat** products in lightweight and heavyweight buildings. All floor covering assemblies shall have prior approval before installation.

II. JOB SITE CONDITIONS

Areas to receive **GenieBoard** should be weather tight and maintained at minimum, a constant relative humidity below 70% and room temperature between 41°F - 95°F (5°C - 35°C) or between 59°F - 95°F (15°C - 35°C) if glued for 48 hours before, during, and after installation.

III. SUBFLOOR REQUIREMENTS AND PREPARATION

NOTE: Please follow the Subfloor requirements and preparation recommendations determined by the flooring manufacturer. Use the following subfloor requirements and preparation guidelines only when no such recommendations exist for the floor product.

1. All subfloors/substrates must be inspected prior to installation.
2. Install **GenieBoard** over wood, concrete, and approved self-levelling materials.
3. Wood subfloors should be double construction with a minimum thickness of one inch. The floor must be rigid and free from movement with a minimum of 18 inches of well ventilated air space below.
4. Wood subfloors (when installed with use of grouted floor coverings like tile) must be prepared according to ANSI L/360 standards, as required by the floor covering manufacturer.
5. Concrete floors must be fully cured and permanently dry. Subfloor shall be dry, clean, smooth, level, and structurally sound. It should be free of dust, solvent, paint, wax, oil, grease, asphalt, sealers, curing and hardening compounds, alkaline salts, old adhesive residue, and other extraneous materials, according to ASTM F710.
6. Subfloor should be smooth to prevent irregularities, roughness, or other defects from affecting the material above it. The surface should be flat to the equivalent of 3/16" in 10', as described in ACI 117R, or as recommended by the floor manufacturer.
7. Mechanically remove all traces of old adhesives, paint, or other debris by scraping, sanding, or scarifying the substrate. DO NOT use solvents.

8. Grind high spots until level and fill low spots with an approved leveling compound.
9. All saw cuts (control joints), cracks, indentations, and other non-moving joints in the concrete must be filled with an approved patching/levelling compound. Allow patching material to dry thoroughly.
10. Any concrete floor can be a source of moisture-related flooring failures. It is the installer's responsibility to test the concrete or other cement-like material for moisture.
11. Maximum moisture vapor emission of the concrete must not exceed 5 lbs/1,000 ft² in a 24-hour period, as measured by the calcium chloride test method in accordance with the ASTM F1869 standard.
12. Maximum relative humidity must not exceed 70% RH, as measured by the relative humidity test method in accordance with the ASTM F2170 standard.

IV. HAZARDS

A. SILICA WARNING

Concrete, floor patching compounds, toppings, and levelling compounds can contain free crystalline silica. Cutting, sawing, grinding, or drilling can produce respirable crystalline silica (particles 1-10 micrometers). Respirable silica is classified by OSHA as a 1A carcinogen and is known to cause respiratory diseases like silicosis. Avoid actions that cause dust to become airborne. Use local or general ventilation or protective equipment to reduce exposure below applicable exposure limits.

B. LEAD WARNING

Certain paints may contain lead. Exposure to excessive amounts of lead dust presents a health hazard. Refer to applicable federal, state, and local laws and the publication, *Lead Based Paint: Guidelines for Hazard Identification and Abatement in Public and Indian Housing*, available from the United States Department of Housing and Urban Development.

C. ASBESTOS WARNING

Resilient flooring, backing, lining felt, paint, or asphaltic "cutback" adhesives could contain asbestos fibers. Avoid actions that cause dust to become airborne. DO NOT sand, dry sweep, dry scrape, drill, saw, beadblast, mechanically chip, or pulverize. Regulations may require that the material be tested to determine asbestos content. Consult the documents titled, *Recommended Work Practices for Removal of Existing Resilient Floor Coverings*, available from the Resilient Floor Covering Institute.

V. MATERIAL STORAGE AND HANDLING

1. Deliver the material to the job site in its original unopened packaging with all labels intact and stored appropriately to prevent damage.

GENIEBOARD® 300 SERIES

HIGH DENSITY GYPSUM FIBREBOARD



It's not magic, it's engineering.®

2. Inspect all material for visual defects before beginning the installation. **Pliteq** will honor no labor or shipping claims on material installed with any visually apparent defects.
3. Verify the material delivered is the correct type, thickness, and amount. Report any discrepancies immediately.
4. The material and any adhesive must be acclimated at room temperature for a minimum of 24 hours before starting the installation.
5. Roll material is stretched slightly when it is rolled at the factory. At the job site, the installer should allow all cuts to relax before gluing down. Shaking the material once it is unrolled can help it to relax more quickly.

Products

I. GenieBoard 300 Series

A. DESCRIPTION

A dry flooring panel that can be used as an alternative to cementitious topping or multiple plywood and cement board layers.

B. APPLICATION

Can be used directly under all flooring types and on top of all **GenieMat** products in lightweight and heavyweight buildings.

II. GenieMat PMI

A. DESCRIPTION

Flat, resilient, single-ply white polyethylene foam perimeter isolation strip that is used to build a tub around the floor so that no hard floor covering surface touches any hard vertical surface (protrusion or wall).

B. APPLICATION

Attached at the base of the perimeter wall of the entire subfloor, as well as the perimeter of any protrusions, prior to unrolling and installing **GenieMat/GenieBoard** products, in order to isolate or break the vibration transmission path between the floor and the wall.

III. Pliteq FAS-B

A. DESCRIPTION

Pliteq FAS-B is a one-component, 100% solids, modified silane polymer-based adhesive. It is solvent-free, water-free, isocyanate-free, nonflammable, has low-odor, negligible VOC content, contains no hazardous chemicals as per OSHA Regulation CFR 1910.1200, and meets all federal, state, and local government indoor air quality regulations. This specifically formulated adhesive has an early grab that is fast curing and is easy to clean.

For Your Project Specific Questions

T. 416.449.0049 | E. info@pliteq.com

© Pliteq Inc. 2025.
®™ Trademarks of Pliteq Inc. The information provided is accurate to the best of our knowledge at the time of issue. However, we reserve the right to make changes when necessary without further notification. Suggested application may need to be modified to conform with local building codes and conditions. We cannot accept responsibility for products that are not used, or installed, to our specifications. All listed dimensions are nominal. 10.19

www.pliteq.com

GENIEBOARD® 300 SERIES

HIGH DENSITY GYPSUM FIBREBOARD



It's not magic, it's engineering.®

B. APPLICATION

Pliteq FAS-B is ideal for wet-set glue down applications, engineered for improved adhesion of the **GenieBoard** high density recycled subfloor panels. Its comes in a standard caulking gun format, simplyfying the the application process. This adhesive is suitable for bonding the rebated edges of **GenieBoard** together. This adhesive can also be used to adhere Acrylic Infused Plank, Bamboo and Hardwood (engineered, parquet, solid). Approved substrates and surfaces for **Pliteq FAS-B** include, APA underlayment grade plywood and OSB; association grade particleboard; cement backer board; cementitious and anhydrite screeds; concrete and radiant heated subfloors that do not exceed 85°F (30° C); existing well-bonded non-cushion-backed vinyl; gypsum and lightweight concrete (primed with **Pliteq FAS-PS**); terrazzo (properly prepared with all waxes and surface finishes removed).

Installation

I. GenieMat PMI

A. GenieMat PMI INSTALLATION

1. Roll **GenieMat PMI** perimeter isolation strip to the base of the perimeter wall, of the entire subfloor, as well as the perimeter of any protrusions (Diagram #1a).
2. Tape **GenieMat PMI** to the base of the perimeter wall of the entire subfloor (Diagram #1b).
3. Cut excessive **GenieMat PMI** at the borders (Diagram #1c).

Diagram #1

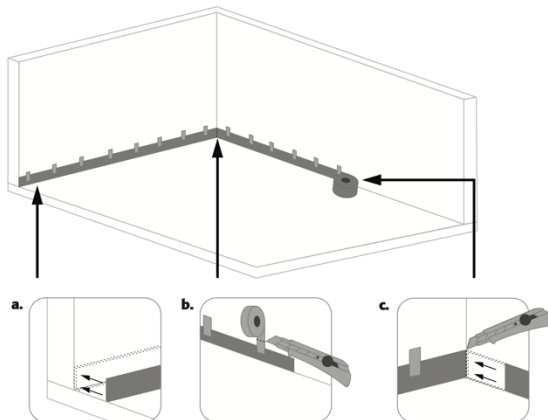

II. GenieBoard 300 Series

A. GenieBoard INSTALLATION

1. Cut off two sides of the shiplap edge of the first **GenieBoard** using a handheld circular saw to insure proper fitting against the wall corner. One cut must be along the long side and the other along the short side (Diagram #2).

For Your Project Specific Questions

T. 416.449.0049 | E. info@pliteq.com

© Pliteq Inc. 2025.

®™ Trademarks of Pliteq Inc. The information provided is accurate to the best of our knowledge at the time of issue. However, we reserve the right to make changes when necessary without further notification. Suggested application may need to be modified to conform with local building codes and conditions. We cannot accept responsibility for products that are not used, or installed, to our specifications. All listed dimensions are nominal. 10.19

www.pliteq.com

GENIEBOARD® 300 SERIES

HIGH DENSITY GYPSUM FIBREBOARD



It's not magic, it's engineering.®

Diagram #2

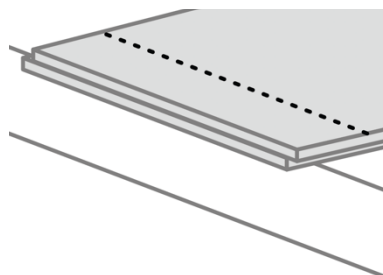

2. For glue down installation, trowel out **Pliteq** approved adhesive no more than a board size from the uninstalled area so that new boards can be laid without disturbing the adhesive. Please contact your local **Pliteq** representative for an approved adhesive recommendation.

3. Begin work at one corner of the room and install **GenieBoard** towards the adjacent corner. Use a handheld circular saw to cut the long edge off boards of the first row (Diagram #3).

Diagram #3



Note: boards should always be fitted in the longitudinal direction of the room.

4. Apply **Pliteq FAS-B** to the shi lap element of the **GenieBoard** then install by connecting the shi lap joints together (Diagram #4).

Diagram #4

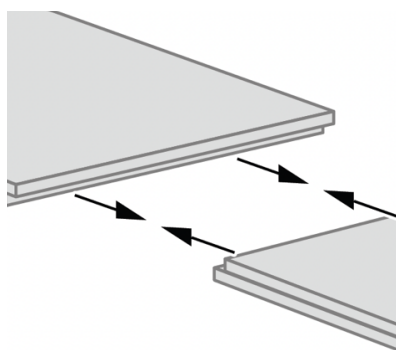

For Your Project Specific Questions

T. 416.449.0049 | E. info@pliteq.com

© Pliteq Inc. 2025.

®™ Trademarks of Pliteq Inc. The information provided is accurate to the best of our knowledge at the time of issue. However, we reserve the right to make changes when necessary without further notification. Suggested application may need to be modified to conform with local building codes and conditions. We cannot accept responsibility for products that are not used, or installed, to our specifications. All listed dimensions are nominal. 10.19

www.pliteq.com

GENIEBOARD® 300 SERIES

HIGH DENSITY GYPSUM FIBREBOARD



It's not magic, it's engineering.®

5. Staple or screw the **GenieBoard** joints every 12" on center using full-thread, self-tapping coarse-thread wood screws within 10 minutes of fitting the boards together to prevent lipping (see Diagram #5).

Diagram #5

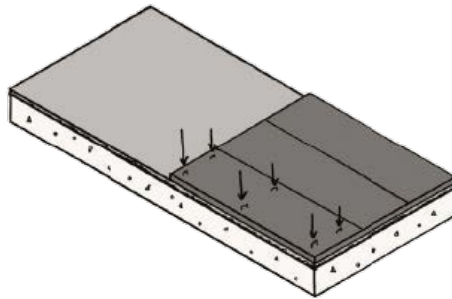

6. Stand on the overlapped edge for a couple of seconds to insure proper transfer of adhesive.
7. Scrap off the excessive glue from the boards. Use a joint filler if required.
8. When you get to the end of an installed row, use a handheld circular saw and trace cut the excess board part. The cut off piece can be used to start the next row. All rows should be offset/staggered from the previous row (Diagram #6).

Diagram #6



Warranty Information

Limited Lifetime Warranty

1. Project Warranty: Refer to Conditions of the Contract for project warranty provisions.
 - 1.1. The recommendations for applications and installation are based on our extensive experience and on current technological practice. Our liability and responsibility in the event of damages is limited to the extent defined in our General Terms and Conditions of Business and is not in any way increased by **Pliteq GenieBoard** Technical Installation Manuals or by advice given by our sales representatives or applications engineering staff.

For Your Project Specific Questions

T. 416.449.0049 | E. info@pliteq.com

© Pliteq Inc. 2025.

®™ Trademarks of Pliteq Inc. The information provided is accurate to the best of our knowledge at the time of issue. However, we reserve the right to make changes when necessary without further notification. Suggested application may need to be modified to conform with local building codes and conditions. We cannot accept responsibility for products that are not used, or installed, to our specifications. All listed dimensions are nominal. 10.19

www.pliteq.com

GENIEBOARD® 300 SERIES

HIGH DENSITY GYPSUM FIBREBOARD



It's not magic, it's engineering.®

- 1.2. **Pliteq Inc.** is a corporation duly organized and validly existing under the laws of the province of Ontario. **Pliteq** offers a limited lifetime warranty on the **GenieBoard** products against defects in material and workmanship and that **GenieBoard** shall meet all published specifications and shall perform effectively. All other warranties including implied warranties for a purpose are expressly excluded. The sole remedy against the seller will be the replacement or repair of the defective goods, or at seller's option, credit may be issued not exceeding the selling price of the defective goods.
- 1.3. To qualify for replacement or repair, a claim is required to be made directly to **Pliteq**. All claims are required to be made by telephone at 416-449-0049 or a written claim can be sent to the following address:

Pliteq Inc.
131 Royal Group Crescent Vaughan, ON
L4H 1X9 Canada
- 1.4. **Pliteq** must be notified within 14 days of the discovery of a defect and prior to installation. Any claims initiated outside of this limitation period are deemed invalid. A **Pliteq** claim form including customer requirements must be completed and submitted to **Pliteq** within 30 days of notification of defect. Once a claim process is initiated, a material inspection may be performed at **Pliteq's** discretion to ensure the situation is resolved in a comprehensively fair manner.

General Terms and Conditions of Business

Our general terms and conditions of business, as may be amended from time to time, shall apply to all transactions between us and our customers. Any differing conditions or terms of buyer are herewith objected to and shall not apply. Any agreement affecting the execution of this contract must be in writing.

We reserve the right to adapt prices, for confirmed orders as well, to reflect any increase in our costs, for any reason beyond our control, if this increase happens after confirmation of order but before delivery of goods. Our prices do not include taxes. Confirmed delivery dates are not fixed dates, unless stated otherwise. Samples and catalogues are to be considered non-binding material for illustration and/or test purposes, giving only an approximation of properties and specification. Unless agreed otherwise, our invoices are to be paid with payment terms of 30 days upon receipt of merchandise and invoice.

Should a customer fail to comply within 30 days, he will automatically be in default of payment. Payment is considered made when it is at our disposal. Should there be reasons to doubt the solvency or credit standing of the client, we reserve the right to demand securities or prepayment for any outstanding delivery or declare immediate maturity of all outstanding claims. Our technical advice is given according to our best knowledge and experience and proven laboratory testing.

We charge a 25% restocking fee for items not received on an Order Acknowledgement, or, for items returned to us. Without agreed upon ship dates, storage fees of \$16USD/pallet/month will be charged to the customer. Discounts for TL (truckload) orders are only applied to orders that require 30 days lead time on delivery and this is at the companies discretion (we may ship sooner if the product is available). For all warranty information please see specific product specification guides as found on our website.

For Your Project Specific Questions

T. 416.449.0049 | E. info@pliteq.com

© Pliteq Inc. 2025.
®™ Trademarks of Pliteq Inc. The information provided is accurate to the best of our knowledge at the time of issue. However, we reserve the right to make changes when necessary without further notification. Suggested application may need to be modified to conform with local building codes and conditions. We cannot accept responsibility for products that are not used, or installed, to our specifications. All listed dimensions are nominal. 10.19

www.pliteq.com