

## Base Preparation

### I. GENERAL INFORMATION

The **GenieMat** line of products for impact sound insulation is engineered to provide better performance than any other sound control product available, and has been rigorously tested to achieve proven results. Made from up to 94% recycled rubber content and backed by over 100 independent laboratory and field tests, **GenieMat** has been selected and used in some of the best hotels and condominiums in the world.

With the use of **GenieMat FAS**, **GenieMat FAS3**, and **GenieMat FASHM** adhesives, it can be installed under a variety of floor finishes and coverings, including nail-down and floating hardwood, engineered wood, and laminate, ceramic, stone, porcelain, and marble tile, luxury vinyl tile (LVT), vinyl sheet, plank, and tile and carpet, in wood, steel, and concrete construction. All floor covering assemblies shall have prior approval before installation.

### II. JOB SITE CONDITIONS

Areas to receive **GenieMat** should be weather tight and maintained at minimum, a constant room temperature between 65°F - 95°F (18°C - 35°C) for 48 hours before, during, and after installation.

### III. SUBFLOOR REQUIREMENTS AND PREPARATION

**NOTE:** Please follow the subfloor requirements and preparation recommendations determined by the flooring manufacturer. Use the following subfloor requirements and preparation guidelines only when no such recommendations exist for the floor finishing product.

1. All subfloors/substrates must be inspected prior to installation.
2. Install **GenieMat** over wood, concrete, and approved self-levelling materials.
3. Wood subfloors should be double construction with a minimum thickness of one inch. The floor must be rigid and free from movement with a minimum of 18 inches of well-ventilated air space below.
4. Wood subfloors (when installed with use of grouted floor coverings like tile) must be prepared according to ANSI L/360 standards, as required by the floor covering manufacturer.
5. Concrete floors must be fully cured and permanently dry. Subfloor shall be dry, clean, smooth, level, and structurally sound. It should be free of dust, solvent, paint, wax, oil, grease, asphalt, sealers, curing and hardening compounds, alkaline salts, old adhesive residue, and other extraneous materials, according to ASTM F710.
6. Subfloor should be smooth to prevent irregularities, roughness, or other defects from affecting the material above it. The surface should be flat to the equivalent of 3/16" in 10', as described in ACI 117R, or as recommended by the floor manufacturer.

7. Mechanically remove all traces of old adhesives, paint, or other debris by scraping, sanding, or scarifying the substrate. DO NOT use solvents.
8. Grind high spots until level and fill low spots with an approved leveling compound.
9. All saw cuts (control joints), cracks, indentations, and other non-moving joints in the concrete must be filled with an approved patching/levelling compound. Allow patching material to dry thoroughly.
10. Any concrete subfloor can be a source of moisture-related flooring failures. It is the installer's responsibility to test the concrete or other cement-like material for moisture.
11. Maximum moisture vapor emission of the concrete must not exceed 5 lbs/1,000 ft<sup>2</sup> in a 24-hour period, as measured by the calcium chloride test method in accordance with the ASTM F1869 standard. If vapor emissions exceed acceptable limits, **GenieMat FASHM**, or a **Pliteq** recommended vapor retardant must be used.
12. Maximum relative humidity must not exceed 85% RH, as measured by the relative humidity test method in accordance with the ASTM F2170 standard. If relative humidity exceeds acceptable limits, **GenieMat FASHM** adhesive, or a **Pliteq** recommended vapor retardant must be used.

#### IV. HAZARDS

##### A. SILICA WARNING

Concrete, floor patching compounds, toppings, and levelling compounds can contain free crystalline silica. Cutting, sawing, grinding, or drilling can produce respirable crystalline silica (particles 1-10 micrometers). Respirable silica is classified by OSHA as a 1A carcinogen and is known to cause respiratory diseases like silicosis. Avoid actions that cause dust to become airborne. Use local or general ventilation or protective equipment to reduce exposure below applicable exposure limits.

##### B. LEAD WARNING

Certain paints may contain lead. Exposure to excessive amounts of lead dust presents a health hazard. Refer to applicable federal, state, and local laws and the publication, *Lead Based Paint: Guidelines for Hazard Identification and Abatement in Public and Indian Housing*, available from the United States Department of Housing and Urban Development.

##### C. ASBESTOS WARNING

Resilient flooring, backing, lining felt, paint, or asphaltic "cutback" adhesives could contain asbestos fibers. Avoid actions that cause dust to become airborne. DO NOT sand, dry sweep, dry scrape, drill, saw, beadblast, mechanically chip, or pulverize. Regulations may require that the material be tested to determine asbestos content. Consult the documents titled, *Recommended Work Practices for Removal of Existing Resilient Floor Coverings*, available from the Resilient Floor Covering Institute.

### V. MATERIAL STORAGE AND HANDLING

1. Deliver the material to the job site in its original unopened packaging with all labels intact and stored appropriately to prevent damage.
2. Inspect all material for visual defects before beginning the installation. **Pliteq** will honor no labor claims on material.
3. Verify the material delivered is the correct type, thickness, and amount. Report any discrepancies immediately.
4. The material and any adhesive must be acclimated at room temperature for a minimum of 24 hours before starting the installation.
5. Roll material is stretched slightly when it is rolled at the factory. At the job site, the installer should allow all cuts to relax before gluing down. Shaking the material once it is unrolled can help it to relax more quickly.

## Products

### I. GenieMat PMI

#### A. DESCRIPTION

Flat, resilient, single-ply white polyethylene foam perimeter isolation strip that is used to build a tub around the floor so that no hard floor covering surface touches any hard vertical surface (protrusion or wall).

#### B. APPLICATION

Attached at the base of the perimeter wall of the entire subfloor, as well as the perimeter of any protrusions, prior to unrolling and installing **GenieMat** products, in order to isolate or break the vibration transmission path between the floor and the wall.

### II. GenieMat DH

#### A. DESCRIPTION

Robust reduced sound transmission mat made from 94% recycled rubber content used when superior sound control is required in multifamily housing, high-rises, or commercial buildings. It is available in rolls and five nominal thicknesses - 3mm, 7mm, and 11mm.

#### B. APPLICATION

Used directly under a variety of floor coverings in wood, steel, and concrete construction, yielding exceptional results for impact sound insulation and substrate crack prevention.

### III. GenieMat DH PRO

#### A. DESCRIPTION

Robust reduced sound transmission mat made from 94% recycled rubber content used when superior sound and moisture control is required in multifamily housing, high-rises, or commercial buildings. Allows for the immediate same day installation of the sound and moisture control as well as the finished ceramic tile and dimension stone. It is available in rolls and four nominal thicknesses - 3mm, 5mm, 10mm, and 12mm. Custom sizes and thicknesses are available upon request.

#### B. APPLICATION

Used directly under a variety of floor coverings in wood, steel, and concrete construction, yielding exceptional results for impact sound insulation, substrate crack prevention and load bearing bonded waterproofing membranes for thin-set tile and dimension stone.

### IV. GenieMat FAS

#### A. DESCRIPTION

GenieMat FAS is a Modified Silane, one component 100% solids, solvent free and isocyanate free adhesive that has 0.1 g/L VOC content, contains no hazardous chemicals as per OSHA Regulation CFR 1910.1200 and is a nonflammable, low odor adhesive that meets all federal, state, and local governmental indoor air quality regulations. This specially formulated adhesive has good early strength buildup for immediate grab and quickly builds into a tenacious but elastic resilient bond as the adhesive cross-links. This adhesive is easy to clean up, even after it has dried on the flooring surface. When used according to directions this adhesive forms a solid membrane below the flooring to protect it from subfloor moisture. Concrete floors over one year old with high moisture readings are usually indicative of a chronic underlying moisture source problems which must be determined prior to the flooring installation.

#### B. APPLICATION

**GenieMat FAS** is ideal for glue-down installations on all grades, for GenieMat sound control underlayments, a broad variety of rubber/recycled rubber/linoleum floors, all types of engineered, solid or acrylic impregnated wood flooring and bamboo, designed to be installed using a wet-set glue down installation method.

### V. GenieMat FAS3

#### A. DESCRIPTION

**GenieMat FAS3** is a firm-set transitional pressure sensitive adhesive with a aggressive fast grab formulation allowing it to handle light foot traffic immediately. It is solvent and isocyanate free adhesive with a high moisture tolerance and extremely low odor and VOCs. It also has excellent plasticizer migration resistance allowing for installation of a wide variety of vinyl based products.

**GenieMat FAS3** will not form a moisture vapor barrier and will not protect flooring from moisture damage. For more information on adhesives within the GenieMat family that will aid in this please contact your local sales representative.

#### B. APPLICATION

**GenieMat FAS3** is ideal for the glue-down installation of GenieMat sound control underlayments, to various subfloors/substrates, and for bonding specified luxury vinyl tile, vinyl plank, both heterogeneous and homogeneous sheet and tile, fiberglass backed sheet, VCT, linoleum, recycled rubber, vinyl backed and nonvinyl backed resilient flooring and rubber flooring to GenieMat sound control underlayments.

### VI. GenieMat FASHM

#### A. DESCRIPTION

**GenieMat FASHM** is a Modified Silane, one component 100% solids, solvent free and isocyanate free adhesive that has less than 0.1 g/L VOC content, contains no hazardous chemicals as per OSHA Regulation CFR 1910.1200 and is a nonflammable, low odor adhesive that meets all federal, state, and local governmental indoor air quality regulations. This specially formulated adhesive has good early strength buildup for immediate grab and quickly builds into a tenacious but elastic resilient bond. This one-part formulated adhesive is a faster, more installer friendly alternative to two-part epoxy systems. It is engineered for heavy rolling loads and challenging environments, and its waterproof design forms an unlimited moisture vapor barrier that can also take the punishment introduced by topical liquids.

**GenieMat FASHM** can form a high strength elastomeric membrane creating a permanent waterproof bond. Allowing for unlimited moisture protection (porous slabs - ASTM F3191) and an unlimited moisture vapor barrier. No RH, pH or MVER testing is required, saving you time and money throughout the installation process.

#### B. APPLICATION

**GenieMat FASHM** is ideal for glue-down installations on all grades, for GenieMat sound control underlayments, a broad variety of vinyl/rubber/ linoleum/sheet floors, all types of engineered, solid or acrylic impregnated wood flooring and bamboo, designed to be installed using a wet-set glue down installation method.

## Installation

### I. GenieMat PMI

#### A. GenieMat PMI INSTALLATION

1. Attach **GenieMat PMI** perimeter isolation strip to the base of the perimeter wall of the entire subfloor, as well as the perimeter of any protrusions (see *Diagram #1*).

Diagram #1

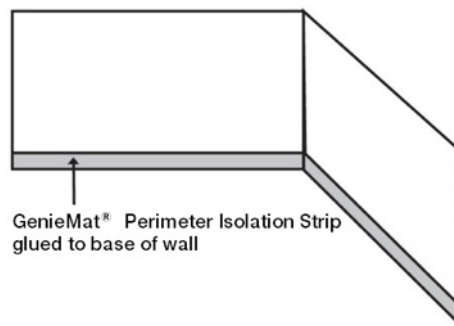

### II. GenieMat DH

#### A. GenieMat DH INSTALLATION

1. Unroll and place **GenieMat DH** underlayment perpendicular to subsequent installation direction of finished floor (see *Diagram #2*).
2. Trim ends of each section to fit floor surface area.
3. Align lengthwise edges of underlayment with neighboring sheets by butting up.
4. Determine whether installation will be floating floor or glue-down and follow the corresponding instructions.

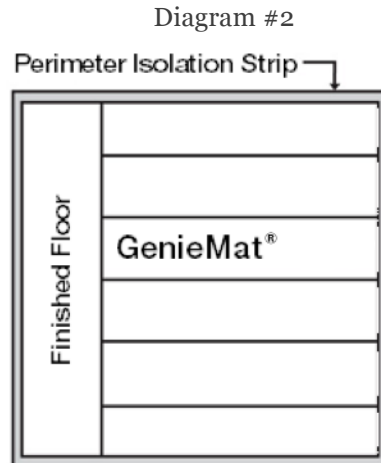

### B. FLOATING FLOOR INSTALLATION

1. Use duct tape or high-quality carpet tape to secure butt joints and seams, and prevent underlayment from moving.
2. Proceed to Finished Floor Installation.

### C. GLUE-DOWN INSTALLATION

1. Fold the first sheet of underlayment halfway lengthwise.
2. Spread adhesive using the appropriate notch trowel and **GenieMat FAS adhesive** (refer to **GenieMat FAS** product spec guide). For alternative adhesives and thinsets, refer to the Recommended Products section on page 9.
3. Carefully lay underlayment into wet adhesive.
4. Fold over second half of first sheet and first half of second sheet.
5. Spread adhesive perpendicular to seam (see *Diagram #3*).
6. Continue this process for each consecutive sheet.
7. Use a 30 to 50 lb roller over sheets to ensure proper transfer of adhesive.
8. Provide enough time to allow adhesive to set before installing finished floor.

Diagram #3

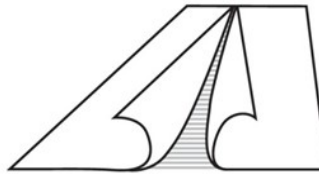

### D. VINYL FLOOR COVERING INSTALLATION

**NOTE:** Follow the flooring manufacturer's directions for the installation of vinyl floor coverings. Seek **Pliteq** approval before using their recommended adhesives, procedures, and equipment.

1. Install self-locking floors, such as vinyl plank, over **GenieMat DH** following the flooring manufacturer's recommendations.
2. Adhere all other vinyl sheet, plank, or tile flooring goods directly to **GenieMat DH** using **GenieMat FAS**, **GenieMat FAS3**, or **GenieMat FASHM** adhesive, depending on the application. Follow instructions on the adhesive pail or those available from **Pliteq** or the flooring manufacturer.
3. When the flooring installation is complete, trim any excess **GenieMat** material so that it is flush with the surface of the floor covering.

## III. GenieMat DH PRO

### A. GenieMat DH PRO INSTALLATION

1. Unroll and place GenieMat DH PRO underlayment perpendicular to subsequent installation direction of finished floor (see Diagram #2 above). The waterproofing membrane should be face up.
2. If the material doesn't extend the entire length or width of the room, it might be necessary to trim the edge of the subsequent sheets.
3. Trim ends of each section to fit floor surface area
4. Align lengthwise edges of underlayment with neighboring sheets by butting up.
5. Fold the first sheet of underlayment halfway lengthwise.
6. Spread Pliteq approved thin-set material using the appropriate notch trowel (refer to thin-set manufacturers Product Spec Guide).
7. Carefully lay underlayment into wet thin set.
8. Fold over second half of first sheet and first half of second sheet.
9. Spread thin set perpendicular to seam (see Diagram #3 above).
10. Continue this process for each consecutive sheet.
11. Use a 30 to 50 lb roller over sheets to embed the GenieMat DH PRO into the thin-set and to ensure proper transfer of thin-set.
12. Measure and cut GenieMat PRO-WPS to size to seal all butt joints and seams including those around vertical protrusions and walls. A minimum 2" overlap must be achieved at all locations.
13. Spread thin-set material using the appropriate notch trowel (refer to thin-set manufacturers Product Spec Guide) along the butt joints and seams and carefully place the GenieMat PRO-WPS into the wet thin-set.



14. Continue this process for each consecutive butt joint and seam.
15. Using a flat trowel press the GenieMat PRO-WPS into the wet thin-set to ensure proper transfer.
16. The ceramic tile or dimensional stone can be installed immediately following Step V below and the manufacturers installation instructions.
17. Please contact your local Pliteq engineer for approval if other installation methods are being considered for your specific project.

#### IV. FINISHED FLOOR

##### A. FINISHED FLOOR INSTALLATION

1. Install all finished floors according to manufacturer's recommendations.
2. If installing a floating finished floor, interlock or glue planks together without gluing the planks to the underlayment.
3. If the manufacturer recommends installation of plywood or cement board between the underlayment and finished floor, adhere the board to the underlayment.

#### V. BASEBOARD

##### A. BASEBOARD INSTALLATION

1. Trim excess **GenieMat PMI** perimeter isolation strip flush or below the surface of the finished floor or vinyl floor covering (see *Diagram #4*).
2. Install baseboard to wall 1/4" minimum above **GenieMat PMI** and floor surface (see *Diagram #4*).
3. Seal entire perimeter with acoustical sealant.

Diagram #4

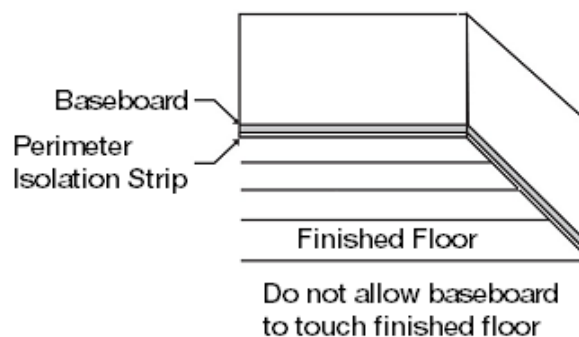

## Recommended Products

**NOTE:** All materials shall be delivered to the job site in the original containers with the manufacturer's identification on each package. Unauthorized modification to any product is not permitted. The following materials are listed because of their extensive testing and field experience with **GenieMat** products. If you would like us to evaluate any materials as alternatives, call **Pliteq** Technical Services at (416) 449-0049.

### I. FLOOR ADHESIVES

- A. **GenieMat FAS, GenieMat FAS3, GenieMat FASHM**
- B. Taylor 2071
- C. Taylor Pinnacle<sup>®</sup>
- D. Taylor Resolute<sup>®</sup>
- E. Bostik's BEST<sup>®</sup>
- F. Henry<sup>®</sup> 971 PlankPro<sup>™</sup>

### II. THIN-SET MATERIALS

- A. Laticrete<sup>®</sup> 253 Gold
- B. Laticrete 254 Platinum
- C. Bostik Single-Flex<sup>®</sup>
- D. ARDEX FB 9 L<sup>™</sup>

### III. GROUT MATERIALS

- A. Laticrete PERMACOLOR<sup>®</sup> Grout
- B. Laticrete SPECTRALOCK<sup>®</sup> Grout
- C. Bostik Hydroment<sup>®</sup> Grout
- D. ARDEX Flex Grout

### IV. ACOUSTICAL SEALANT

- A. Tremco Acoustical Sealant
- B. Pecora AC-20<sup>®</sup> FTR

## Warranty Information

1.1: Project Warranty: Refer to Conditions of the Contract for project warranty provisions.

1.1.1: The recommendations for applications and installation are based on our extensive experience and on current technological practice. Our liability and responsibility in the event of damages is limited to the extent defined in our General Terms and Conditions of Business and is not in any way increased by the above recommendations or by advice given by our sales representatives or applications engineering staff.

1.1.2: **Pliteq Inc.** is a corporation duly organized and validly existing under the laws of the province of Ontario. **Pliteq** offers a limited lifetime warranty on the **GenieMat** brand of Sound Control Underlayment products against defects in material and workmanship and that **GenieMat** shall meet all published specifications and shall perform effectively. **Pliteq** warrants that during the warranty period **GenieMat** shall not harden, become brittle, chip, crack, tear, or exhibit any signs of excessive deterioration except for normal wear and tear. All other warranties including implied warranties for a purpose are expressly excluded. The sole remedy against the seller will be the replacement or repair of the defective goods, or at seller's option, credit may be issued not exceeding the selling price of the defective goods.

1.1.3: To qualify for replacement or repair, a claim is required to be made directly to **Pliteq**. All claims are required to be made by telephone at 416-449-0049 or a written claim can be sent to the following address:

Pliteq Inc.  
131 Royal Group Crescent  
Vaughan, ON  
L4H 1X9  
Canada

1.1.4: **Pliteq** must be notified within 14 days of the discovery of a defect and prior to installation. Any claims initiated outside of this limitation period are deemed invalid. A **Pliteq** claim form including customer requirements must be completed and submitted to **Pliteq** within 30 days of notification of defect. Once a claim process is initiated, a material inspection may be performed at **Pliteq's** discretion to ensure the situation is resolved in a comprehensively fair manner.

## General Terms and Conditions of Business

Our general terms and conditions of business, as may be amended from time to time, shall apply to all transactions between us and our customers. Any differing conditions or terms of buyer are herewith objected to and shall not apply. Any agreement affecting the execution of this contract must be in writing. We reserve the right to adapt prices, for confirmed orders as well, to reflect any increase in our costs, for any reason beyond our control, if this increase happens after confirmation of order but before delivery of goods. Our prices do not include taxes. Confirmed delivery dates are not fixed dates, unless stated otherwise. Samples and catalogues are to be considered non-binding material for illustration and/or test purposes, giving only an approximation of properties and specification. Unless agreed otherwise, our invoices are to be paid with payment terms of 30 days upon receipt of merchandise and invoice. Should a customer fail to comply within 30 days, he will automatically be in default of payment. Payment is considered made when it is at our disposal. Should there be reasons to doubt the solvency or credit standing of the client, we reserve the right to demand securities or prepayment for any outstanding delivery or declare immediate maturity of all outstanding claims. Our technical advice is given according to our best knowledge and experience and proven laboratory testing. We require 50% payment in advance for all GenieMat FIT and 100% payment in advance for all custom orders. All custom orders are noncancellable and cannot be modified after deposit is received. Shipping will be re quoted at the time of shipping, any estimated amount provided prior to that shall be for estimation purposes only. We reserve the right to issue a credit, not a refund, on products that are returned. We will not accept returns without prior authorization. We charge a 50% restocking fee for items not received on an Order Acknowledgement, or, for items returned to us. Any missed pickups from the factory/warehouse will be subject to a \$250USD fee added to the Order Acknowledgment. Same day rush orders will be based on availability (can be the following morning) and will be subject to a \$150USD fee added to the Order Acknowledgment. If a same day rush order is canceled the client will be responsible for the same day rush and restocking fees which will be added to the Order Acknowledgment. **Pliteq** will honor no labor claims on material. All adhesive purchases are final sale. Without agreed upon ship dates, storage fees of \$100 USD/pallet/month will be charged to the customer. Discounts for TL (truckload) orders are only applied to orders that require 30 days lead time on delivery and this is at the companies discretion (we may ship sooner if the product is available). For all warranty information please see specific product specification guides as found on our website.