



**It's not magic, it's engineering.®**

## GENIEBOARD® 302

High Density Mixed Fiber Board

# ELIMINATE GYPSUM CONCRETE IN WOOD FRAME CONSTRUCTION

# FLOOR-CEILING ASSEMBLIES

## Open-Web Wood Trusses

### Market Rate Multifamily Construction

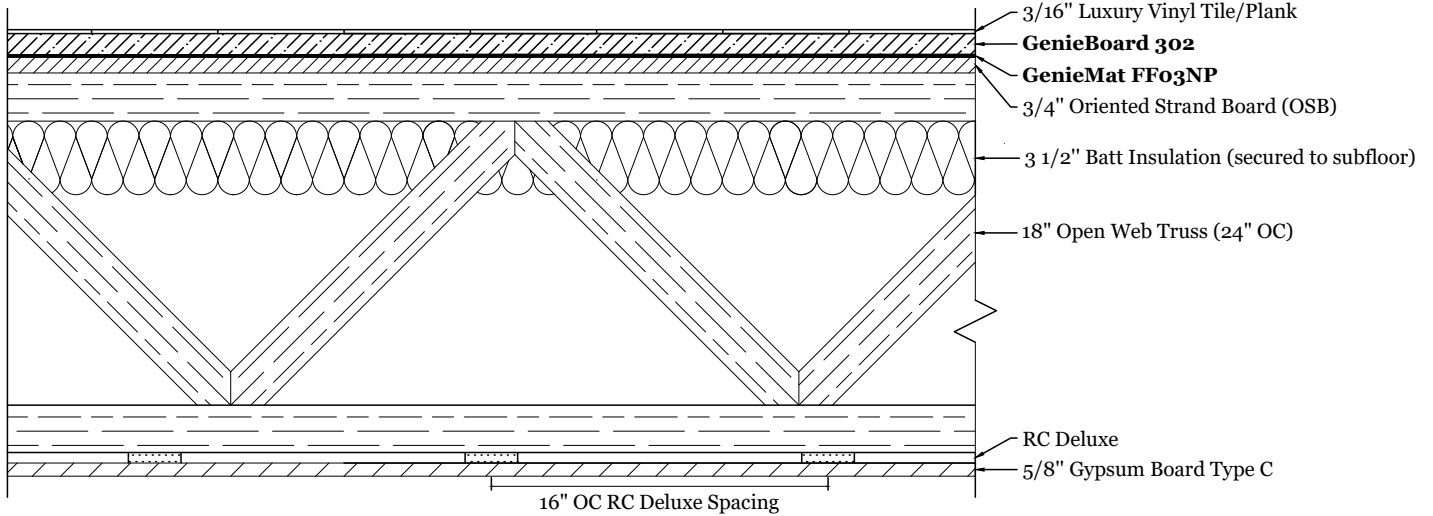

S2324.20

UL L528

### Luxury Multifamily Construction

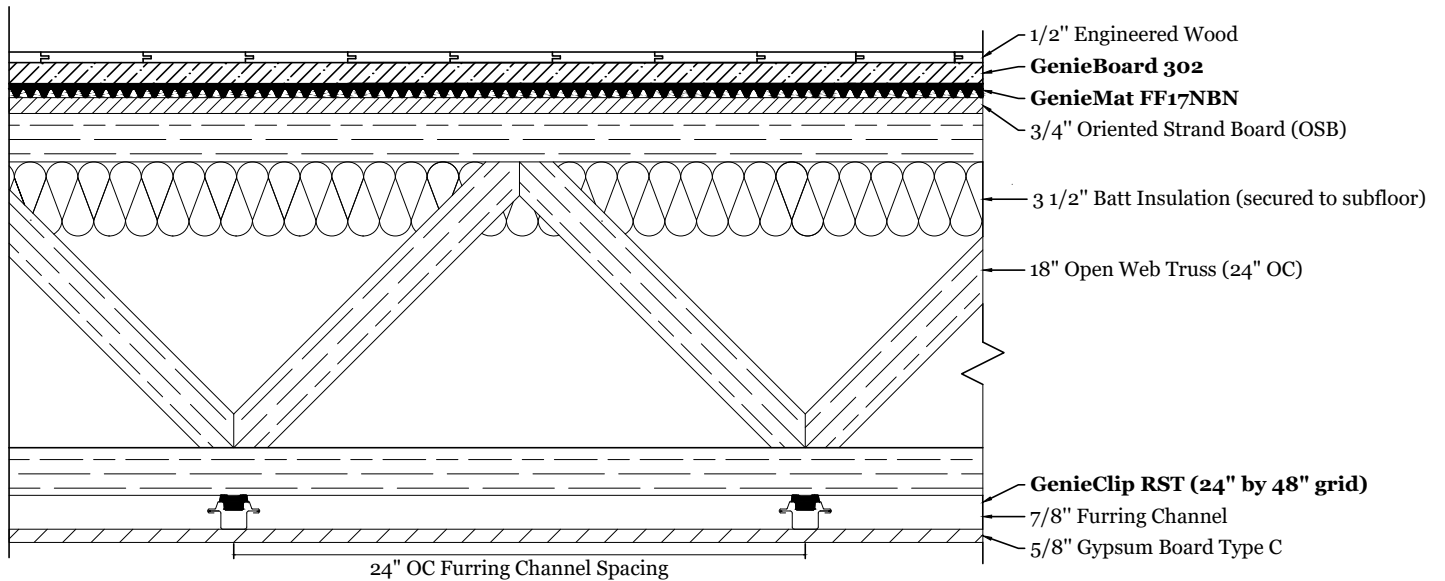

S2324.13

UL L528

# FLOOR-CEILING ASSEMBLIES

## TJI Floor Joist

### Market Rate Multifamily Construction

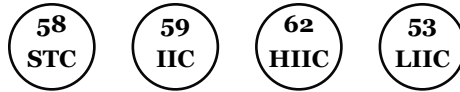
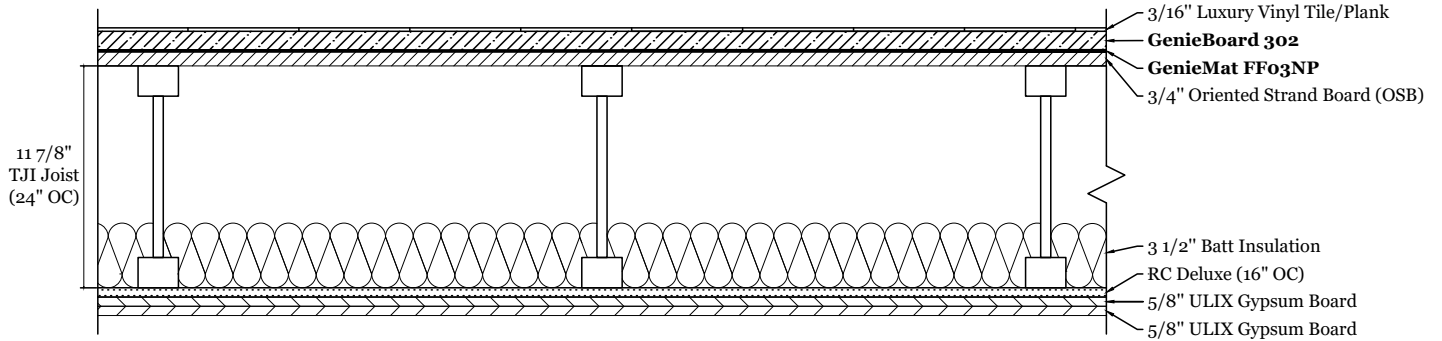

S2326.20

### Luxury Multifamily Construction

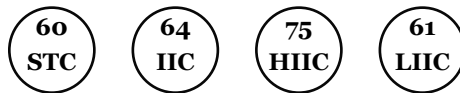
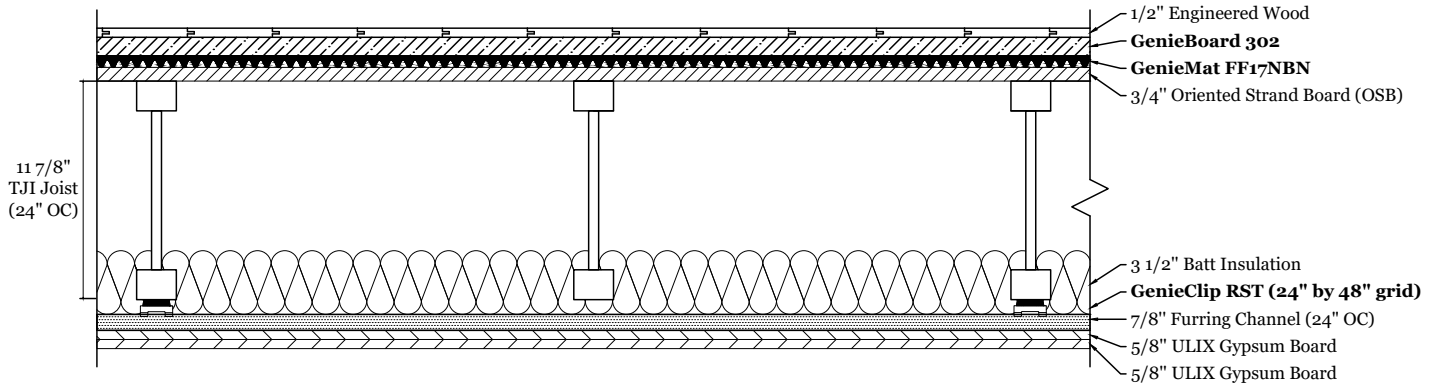

S2326.13

# TEST RESULTS

FLOOR-CEILING ASSEMBLIES									
TEST REPORT NUMBER	CEILING TYPE	STRUCTURE	FINISH FLOOR	UNDERLAYMENT	SUBFLOOR	STC RATING (ASTM E90)	IIC RATING (ASTM E492)	HIIC RATING	LIIC RATING
S2324.00	1/2" RC Deluxe 5/8" GWB Type C	Open Web Truss	None	None	None	55	46	48	36
S2326.00	1/2" RC Deluxe 2 x 5/8" ULIX GWB	Engineered Joist	None	None	None	54	46	46	35
H1768.02	5/8" GWB Type C	Engineered Joist	None	None	1 1/2" Gypsum	54	44	43	42
S2324.20	1/2" RC Deluxe, 5/8" GWB Type C	Open Web Truss	Vinyl Plank	None	<b>GenieBoard 302, GenieMat FF03NP</b>	60	59	63	55
S2324.13	<b>GenieClip RST,</b> 5/8" GWB Type C	Open Web Truss	Wood	None	<b>GenieBoard 302, GenieMat FF17</b>	61	62	72	55
S2326.20	1/2" RC Deluxe, 2 x 5/8" ULIX GWB	Engineered Joist	Vinyl Plank	None	<b>GenieBoard 302, GenieMat FF03NP</b>	58	59	62	53
S2326.13	<b>GenieClip RST,</b> 2 x 5/8" ULIX GWB	Engineered Joist	Wood	None	<b>GenieBoard 302, GenieMat FF17</b>	60	64	75	61
S2324.07	1/2" RC Deluxe, 5/8" GWB Type C	Open Web Truss	Ceramic Tile	<b>GenieMat RST03 PRO</b>	<b>GenieBoard 302, GenieMat FF10</b>	60	60	68	60
S2324.11	<b>GenieClip RST,</b> 5/8" GWB Type C	Open Web Truss	Ceramic Tile	<b>GenieMat RST03 PRO</b>	<b>GenieBoard 302, GenieMat FF10</b>	61	61	70	60
S2324.03	1/2" RC Deluxe, 5/8" GWB Type C	Open Web Truss	Vinyl Plank	None	<b>GenieBoard 302, GenieMat FF17</b>	60	62	69	60
S2324.02	1/2" RC Deluxe, 5/8" GWB Type C	Open Web Truss	Wood	None	<b>GenieBoard 302, GenieMat FF17</b>	60	61	70	58
S2324.17	<b>GenieClip RST,</b> 5/8" GWB Type C	Open Web Truss	Vinyl Plank	None	<b>GenieBoard 302, GenieMat FF03NP</b>	60	60	65	57
S2324.16	<b>GenieClip RST,</b> 5/8" GWB Type C	Open Web Truss	Wood	None	<b>GenieBoard 302, GenieMat FF03NP</b>	60	61	69	56
S2324.05	1/2" RC Deluxe, 5/8" GWB Type C	Open Web Truss	Wood	None	<b>GenieBoard 302, GenieMat FF10</b>	60	61	70	61
S2326.07	1/2" RC Deluxe, 2 x 5/8" ULIX GWB	Engineered Joist	Ceramic Tile	<b>GenieMat RST03 PRO</b>	<b>GenieBoard 302, GenieMat FF10</b>	58	62	68	57
S2326.11	<b>GenieClip RST,</b> 2 x 5/8" ULIX GWB	Engineered Joist	Ceramic Tile	<b>GenieMat RST03 PRO</b>	<b>GenieBoard 302, GenieMat FF10</b>	60	65	71	60
S2326.03	1/2" RC Deluxe, 2 x 5/8" ULIX GWB	Engineered Joist	Vinyl Plank	None	<b>GenieBoard 302, GenieMat FF17</b>	57	64	70	59
S2326.02	1/2" RC Deluxe, 2 x 5/8" ULIX GWB	Engineered Joist	Wood	None	<b>GenieBoard 302, GenieMat FF17</b>	58	64	71	56
S2326.17	<b>GenieClip RST,</b> 2 x 5/8" ULIX GWB	Engineered Joist	Vinyl Plank	None	<b>GenieBoard 302, GenieMat FF03NP</b>	60	62	64	59
S2326.16	<b>GenieClip RST,</b> 2 x 5/8" ULIX GWB	Engineered Joist	Wood	None	<b>GenieBoard 302, GenieMat FF03NP</b>	60	62	68	54